

## GSB-ALG法兰关节轴承 Flange spherical bearings



### 产品特性 Product features

- 耐磨塑料球体内孔安装 ALG高速滑动轴承
  - 保持器采用高强度材料M163制成
  - 最高线速度可达1m/s
  - 干运行、免维护
  - 高尺寸稳定性
  - 补偿中心误差
  - 重量轻、易安装
- Anti-wear plastic ball with high speed sliding bushing ALG
  - Housing made of high strength material M163
  - High speed up to 1m/s
  - Maintenance-free dry operation
  - High dimensional stability
  - Compensation of misalignment errors
  - Very light, easy installation

### 标准规格 Standard specifications

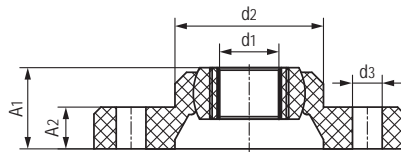
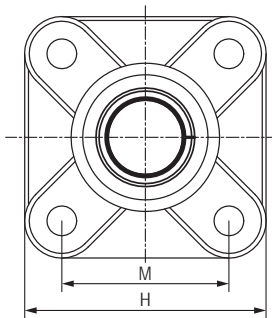

产品编码 Part No.:

GSB-ALG-06

内径 Inner diameter

衬套 Bushings

产品编码 Part No.	d <sub>1</sub> E10 [mm]	d <sub>2</sub> [mm]	d <sub>3</sub> [mm]	A <sub>1</sub> [mm]	A <sub>2</sub> [mm]	M [mm]	H [mm]	最大静载荷 Max. axial static load		最大径向静态负荷 Max. radial static load		最大静态转 矩孔 Max. tight-ening torque -Holes [Nm]	最大调节 角度 Max. adjust angle	重量 Weight [g]
								短期 Short-term [N]	长期 Long-term [N]	短期 Short-term [N]	长期 Long-term [N]			
GSB-ALG-06	6	14	3.2	8.5	4.5	17	25	300	150	1000	500	0.6	25°	3.1
GSB-ALG-08	8	18	4.3	10.5	5.5	22	33	450	225	1400	700	1.3	25°	6.3
GSB-ALG-10	10	22	5.3	12	6.5	26	38	700	350	2000	1000	2.5	25°	9.6
GSB-ALG-12	12	25	5.3	13	7	28	40	850	425	2500	1250	2.5	21°	11.7
GSB-ALG-15	15	30	6.4	15.5	8.5	34	49	1100	550	3000	1500	4.5	20°	21.4
GSB-ALG-16	16	32	6.4	16.5	9	36	52	1350	675	3200	1600	4.5	27°	24.7
GSB-ALG-20	20	40	8.4	20	11	45	65	2000	1000	4000	2000	10.5	19°	47.3
GSB-ALG-25	25	48.5	8.4	25	14	52	74	2400	1200	5600	2800	10.5	15°	79.7
GSB-ALG-30	30	55	10.5	26	15	60	85	2800	1400	6000	3000	21.5	14°	105.6